



THIS PICTURE: Mix it Up and Modern Craft by Carpets Inter provide designers the tools to bring their own vision and concept to corporate offices.



# MAGIC CARPETS

[www.designcorporate.co.ke](http://www.designcorporate.co.ke)

ENGINEERED TO BE HIGH PERFORMANCE AND SUSTAINABLE, CARPETS INTER'S CARPET TILE OFFERS INFINITE DESIGN FLEXIBILITY, MAKING IT THE PERFECT MATCH FOR ANY MODERN OFFICE INSTALLATION.

TOP: This large scale design in three different shades is especially suitable for open areas and can be installed in a myriad of ways.

OFFICECONCEPT.ASIA

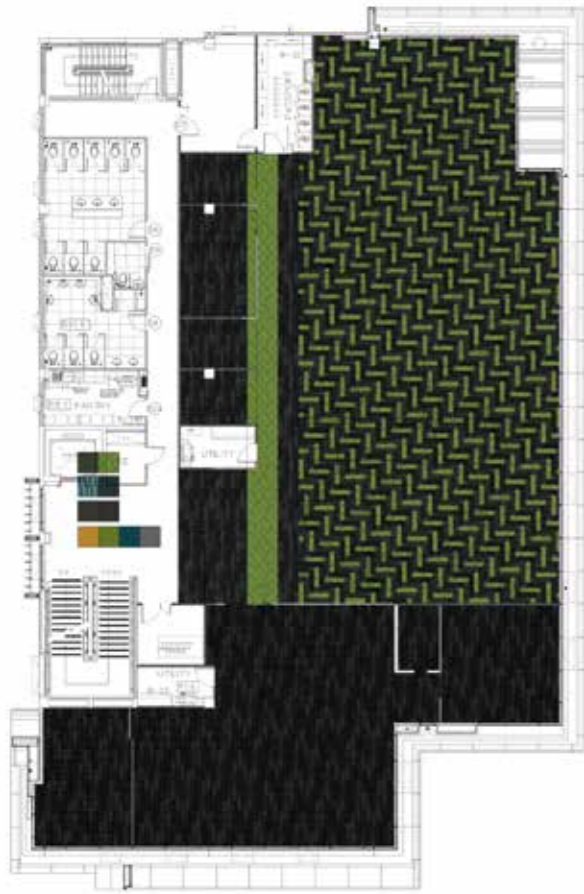

For architects and designers who stress over finding the perfect style, colour and texture of floor covering for office spaces, Carpets Inter, Asia's largest contract carpet manufacturer, has just the answer: Mix It Up carpet tiles.

Thanks to their modular design, these top-grade carpet tiles are cost effective and can be mixed and matched in a multitude of imaginative patterns and styles to create a distinctive look and feel for a workspace while providing walking comfort.

From soft pastels and spare patterns to bold, playful geometric patterns, these highly versatile carpet tiles help to define specific areas by highlighting conference rooms, workspaces and reception areas with a standout design, colour or tile layout.

To raise the design bar even higher, Carpets Inter's design team has rolled out Modern Craft, an extension of the Mix It Up concept. Clients can customize their floor using modified tile shapes and sizes, thus adding another layer of creativity in terms of floor layout. Available in wide planks, skinny planks, mini planks, triangles, and square tiles, the Modern Craft carpet tiles are entirely adaptable to the needs of a project and can be used individually or in combination with 50x50cm square tiles to achieve a truly unique and inspired design for an office installation of any size.



**TOP LEFT:** With the Modern Craft technique, Carpets Inter introduces several different shapes that can be combined to create limitless floor layouts.

**TOP RIGHT:** Solid colour choices, when measured against black, can create a visual appeal anywhere from elevating to frankly playful.



In fact, there's more to Carpet Inter's carpet tiles than meets the eye — or foot. A machine-tufted loop made from 100% Nylon BCF with stain protector and soil repellence, these carpet tiles offer an array of additional benefits, such as ease of installation, and under floor maintenance with minimum disruption. And should the carpet flooring become ripped or damaged, the solution is as simple as replacing one or two tiles.

Green-conscious buyers can opt for a hard backing that features EcoSquare® PVC, a new generation of recycled content PVC carpet tile hard backing, and EcoSoft®, an eco-friendly cushion backing. Providing twice the sound absorption when compared to 'hard-backed' carpet tile, the EcoSoft® contains the equivalent of 37 recycled 600 ml PET drinking water bottles per square metre, is PVC- and bitumen-free, and is 100% recyclable.

[carpetsinter.com](http://carpetsinter.com)

**TOP:** This floor layout precisely complements and enhances the interior environment with a quiet and practical aesthetic.



**BOTTOM:** A colourful combo of Mix-It-Up and Modern Craft carpet tiles energizes an open office workspace and says, 'Welcome.'